

The DiGi Module XT Series delivers precision point-source illumination for architectural accent lighting, decorative installations, and commercial applications requiring individual LED control and superior environmental durability. This compact module is perfect for flexible integration across hospitality, retail, and architectural projects demanding reliable point-source lighting solutions.

Engineered with premium housing and lens construction rated to IP67 with 110° beam angle coverage, the XT Series operates reliably in demanding outdoor environments. Available in XT3 and XT6 configurations with black or beige housing options and a variety of covers, this modular system provides great versatility, precise control and long-term reliability.

➤ Dual Power Architecture – XT3 and XT6 configurations with premium LEDs for scalable installation requirements.

➤ Complete Control Integration – Extensive data run lengths trough SPI with IP67 environmental protection for maximum design flexibility.

CE

RoHS



IP67

IK08



Specifications

General		
Power Consumption (W/m)	XT3	0,8
	XT6	1,4
Input Voltage (V DC)	24	
LEDs (/module)	XT3	3
	XT6	6
Pixels (/module)	1	
Channels (/module)	3	
LED Type	3in1	
Color Range	RGB	
Beam Angle (°)	110	
Control	SPI	
Dimming	16 bit	

Installation Conditions & Lighting Data		
Minimum Pixel Pitch ¹ (mm)	80	
Maximum String Length ¹ (m)	15	
Maximum Run Length Power ¹	Distance (m)	30
	XT3 (modules)	170
	XT6 (modules)	128
Maximum Run Length Data ¹ (modules)	@30fps	850
	@50fps	510
Maximum Leader Cable Length ¹ (m)	Up to 20	
Delivered Lumen Full RGB (lm)	45 (XT6 RGB Flat Cover)	
Lumen Maintenance Calculated Hours (h)	L80B10 50,000	

¹ More details can be found in the Installation Guide document.

Operating	
Environment	Outdoor
Storage Temperature (°C)	-40 to +60
Working Temperature (°C)	-25 to +55
Coastal Environmental Proof	Yes
Saltwater Resistant	Yes
UV Resistant	Yes
Flame Resistant	Yes
IK Rating	IK08
IP Rating	IP67
Certification	CE, RoHS, ETL
Limited Warranty	5 Years

Physical	
Housing Material	ABS
Cable Material	PCP
Connector Material	Nylon (PA66)
Cover Material	PC
Housing Color	Black / Beige
Cable Color	Black / Beige
Connector Type	M16 5Pin
Dimensions LxWxH (mm)	46 x 42 x 21,7
Weight (kg/module)	0,025

Options

Covers	
<input type="checkbox"/> Flat Transparent	<input type="checkbox"/> Dome
<input type="checkbox"/> Globe	<input type="checkbox"/> Turbo
Accessories	
<input type="checkbox"/> Mounting Clip	<input type="checkbox"/> Panel Ring
<input type="checkbox"/> Mounting Profile	

Lighting Specifications

DiGi Module XT

	Full RGB (lm/m)	Red (lm/m)	Green (lm/m)	Blue (lm/m)
XT3 RGB				
XT6 RGB	45	10	30	6

	Red (nm)	Green (nm)	Blue (nm)
Spectral Information	620-625	520-525	465-470

Photometric Distribution

Dimensions

DiGi Module XT Multi Color¹

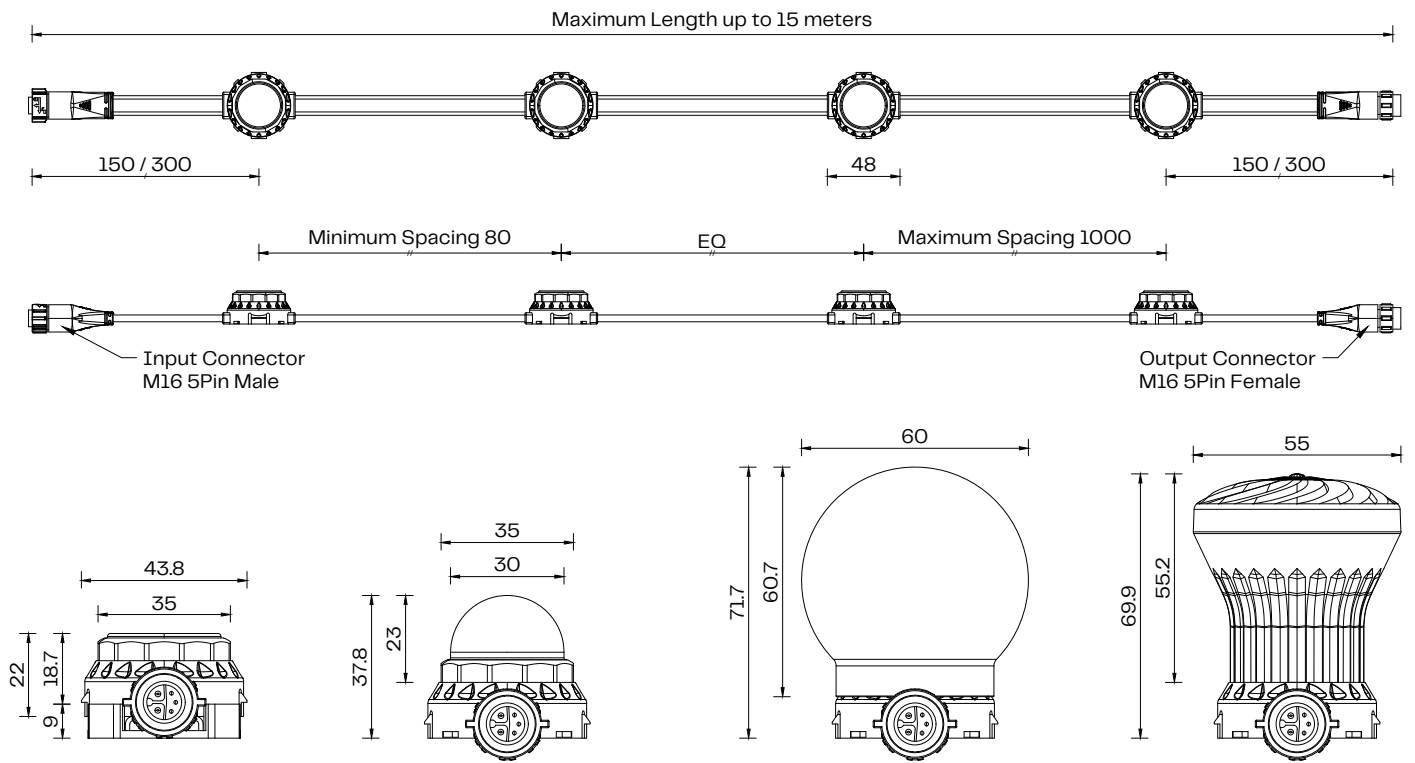

¹ The dimensions shown are not to scale. Please refer to the Dimensions Sheet document for additional dimensions.

Accessory Options

Mounting Clip

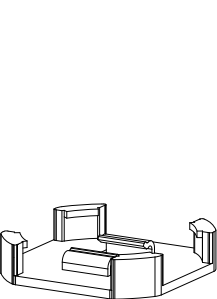

Dome Cover

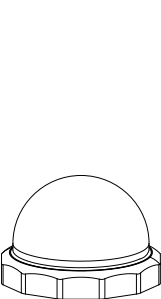

Globe Cover

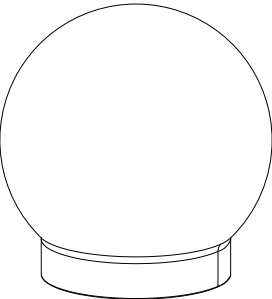

Turbo Cover

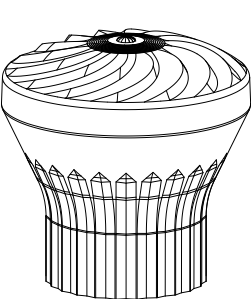

Panel Ring

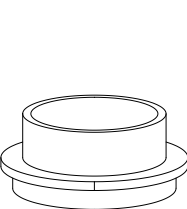

Mounting Profile XT

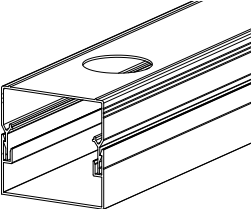

Profile Specification

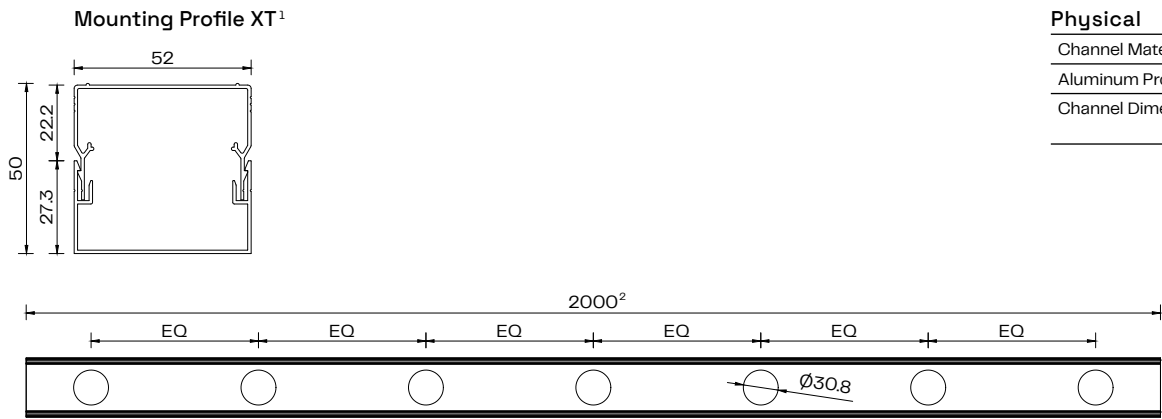

¹ The dimensions shown are not to scale. Please refer to the Dimensions Sheet document for additional dimensions.

² 2000mm profile and 200mm pitch hole cut-out are standard. Custom lengths are available upon request.

Physical	
Channel Material	Aluminum Alloy 6063
Aluminum Profile Finish	Blank Anodized
Channel Dimensions	Hole arrangement based on ordered Module XT Pitch

Connection

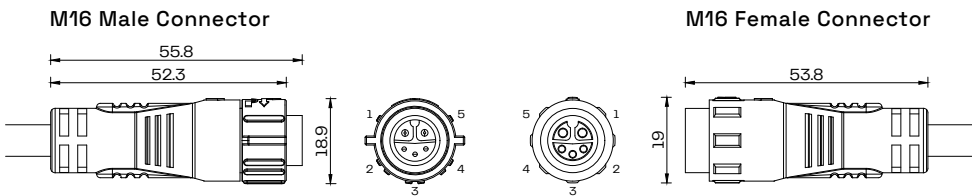

Connector Pin		
Pin 1	Red	24 V+
Pin 2	Green	Data +
Pin 3	White	Program
Pin 4	Yellow	Data -
Pin 5	Black	GND

Product References

DiGi Module XT

Reference	Description
	DiGi Module XT3 RGB Black
	DiGi Module XT3 RGB Beige
	DiGi Module XT6 RGB Black
	DiGi Module XT6 RGB Beige

Accessories

Reference	Description
	Globe Cover
	Turbo Cover
	Dome Cover
	Panel Ring
	Mounting Profile XT
	Mounting Clip