



Essential Safety Notes!

Switch off power during installation and maintenance.

Do not attempt installation in wet or severe weather conditions.

Protect cables from sharp edges and objects to prevent damage.

Ensure unused connectors and fixtures are not exposed to harsh or wet weather conditions, this might lead to corrosion and malfunction.

Fixtures and cables are IP and IK rated. Ensure that the installation environment complies with the specified protection ratings.

Fixation

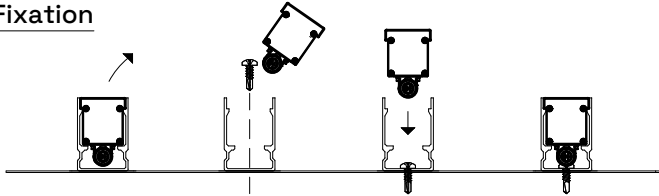

↘ Mount using the provided Ø5mm holes in the bracket.
Once fixed place the fixture in the bracket and push down till fixture is locked in place.

Alignment

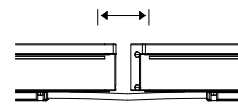

↘ Maintain a minimum spacing of 4mm to allow thermal expansion between fixture's.

Wiring

Leader Cable

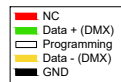

Power Cable

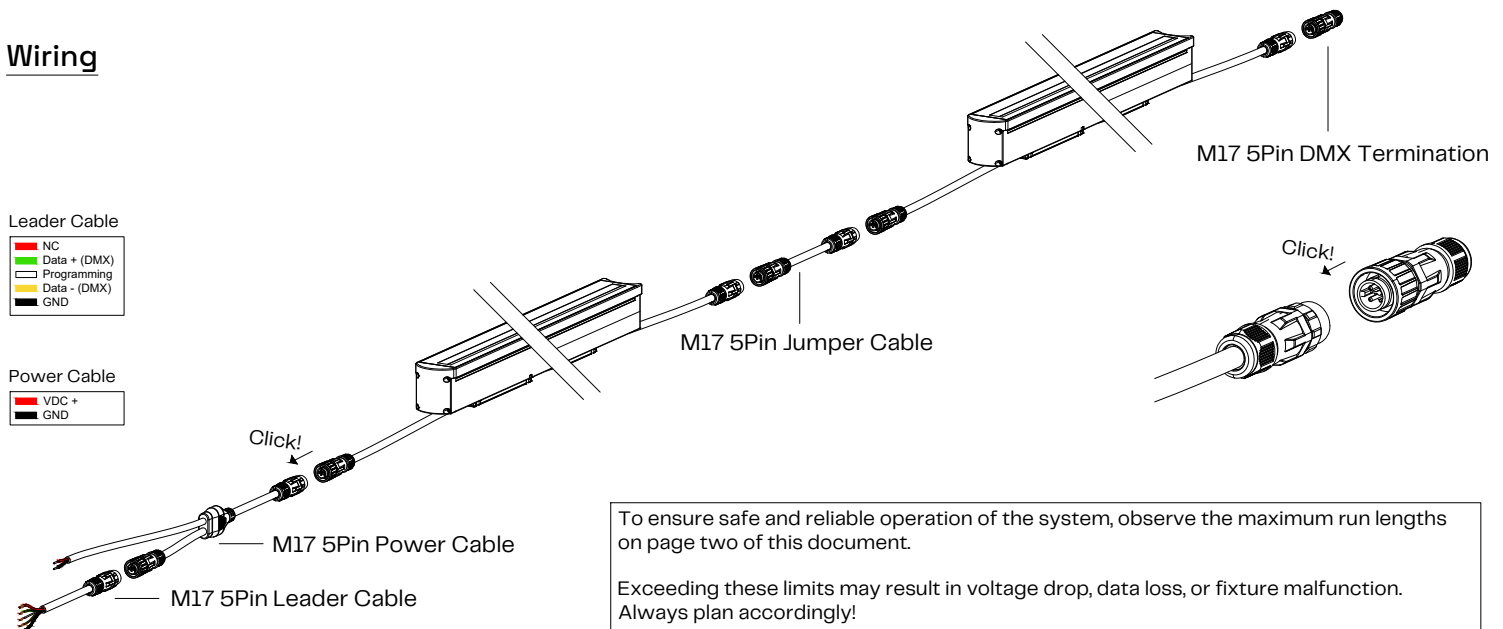
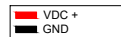

To ensure safe and reliable operation of the system, observe the maximum run lengths on page two of this document.

Exceeding these limits may result in voltage drop, data loss, or fixture malfunction. Always plan accordingly!

↘ Begin by connecting the leader cable from the DMX controller to the power cable and to the first fixture in the run.

↘ Connect each subsequent fixture's input connector to the previous fixture's output connector.

↘ Use jumper cables between fixtures if necessary.

↘ Finish by installing the end cap on the output connector of the last fixture to guarantee the required sealing.

Wiring Setup Example

